

# UPS High Rate Battery

UPS12-100WFR



Specifications	
Nominal Voltage	12V
Nominal Capacity	92.8 Watts/cell (15 Min. rate to 1.67V/cell @ 77°F) 27Ah (20 Hr. rate to 1.80 V/cell @ 77°F)
Dimensions	Length 6.46 inches
	Width 4.92 inches
	Height (with Terminal) 6.89 inches
Weight	Approx. 17.4 lbs. (7.9 kg)
Container Material	ABS - Flame Retardant UL94
Terminal / Torque Rating	T12 / 45 in. lbs.
Preferred Operating Temp.	68-77°F
Operating Temp Range	Discharge: -15~50°C (5~122°F)
	Charge: 0~40°C (32~104°F)
	Storage: -15~40°C (32~104°F)
Internal Resistance	Approx. 10 mOhms
Max. Discharge Current	540A (5s)
Float Voltage	2.25 – 2.28 Vpc at 77°F
Max. Charge Current Allowed	8.1 Amps
Self Discharge	3% of capacity declined per month at 20°C (68°F). The batteries may be stored for up to 6 months at 25°C (77°F) and then a freshening charge is required. For higher temperatures the time interval will be shorter.

### Applications

- UPS (High rate)
- High power backup supply
- Emergency power supply
- Emergency lighting
- Electric starting



UL File No. MH19767

Constant Power Discharge (Watts/Cell) at 25°C (77°F)							
F.V/Time	5 min	10 min	15 min	20 min	30 min	45 min	1 hr
1.85 V/cell	121.5	93.3	76.8	65.3	51.0	38.9	31.7
1.80 V/cell	137.1	102.2	82.2	68.4	53.6	40.8	33.4
1.75 V/cell	154.5	108.1	86.6	72.3	55.3	41.7	34.1
1.70 V/cell	167.8	114.3	89.2	74.2	56.6	42.6	34.8
1.67 V/cell	177.1	118.7	92.8	76.3	57.9	43.4	35.5
1.60 V/cell	181.9	121.3	94.8	78.2	59.3	44.0	35.9

Constant Current Discharge (Amperes) at 25°C (77°F)							
F.V/Time	5 min	10 min	15 min	20 min	30 min	45 min	1 hr
1.85 V/cell	62.5	47.7	39.0	33.0	25.7	19.5	15.8
1.80 V/cell	71.2	52.8	42.2	34.9	27.2	20.6	16.8
1.75 V/cell	81.1	56.4	44.8	37.3	28.3	21.3	17.3
1.70 V/cell	89.1	60.3	46.8	38.6	29.2	21.9	17.7
1.67 V/cell	94.8	63.0	48.9	40.1	30.1	22.5	18.2
1.60 V/cell	98.5	65.1	50.5	41.5	31.1	23.0	18.6

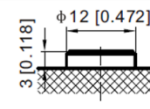
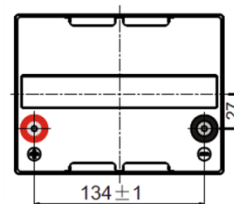
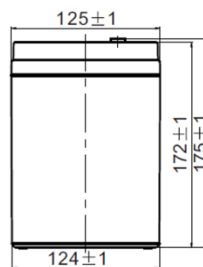
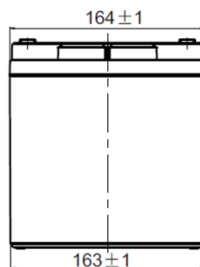

Unit: mm [inches]